



ECLISSE
40 COLLECTION



ECLISSE 40 Collection

The frame seen from
a new perspective.

Not settling for the status quo, not taking anything for granted and constantly challenging the world view creates the space to design from a new perspective. Because just when you think you know something, you have to change your approach and look at it from a new angle.

The frame is now
experiencing a new
revolution, a great
innovation called the
ECLISSE 40 Collection.



40°



Inspiration comes from the past

ECLISSE 40 is the brainchild of the two designers, Francesco Valentini and Lorenzo Ponzelli.



"It all came from the feeling that something was missing from the world of doors. Something that would evolve the very concept of a flush-to-the-wall door or a minimal door. Certain that creativity arises from the negation of a possibility, or from necessity itself, we imagined something that would leave a sign of its presence, a decorative element. This had to be done not by adding, but by removing material, and visible had to be created from invisible. All this without neglecting the functional and practical aspect: we also wanted to create a protective element for the sharp edges between the wall and the door. And so we did".



Inspiration takes its cue from observation

In ancient buildings, especially in the Romanesque and Gothic period, walls in proximity to windows were inclined and widened towards the interior of the room.

The aim was to direct as much light as possible inside, even from small openings. In architecture, the technique is identified with the term "splay".

Discovery consists of seeing what everybody has seen,
and thinking what nobody has thought.

A. Szent-Gyorgyi

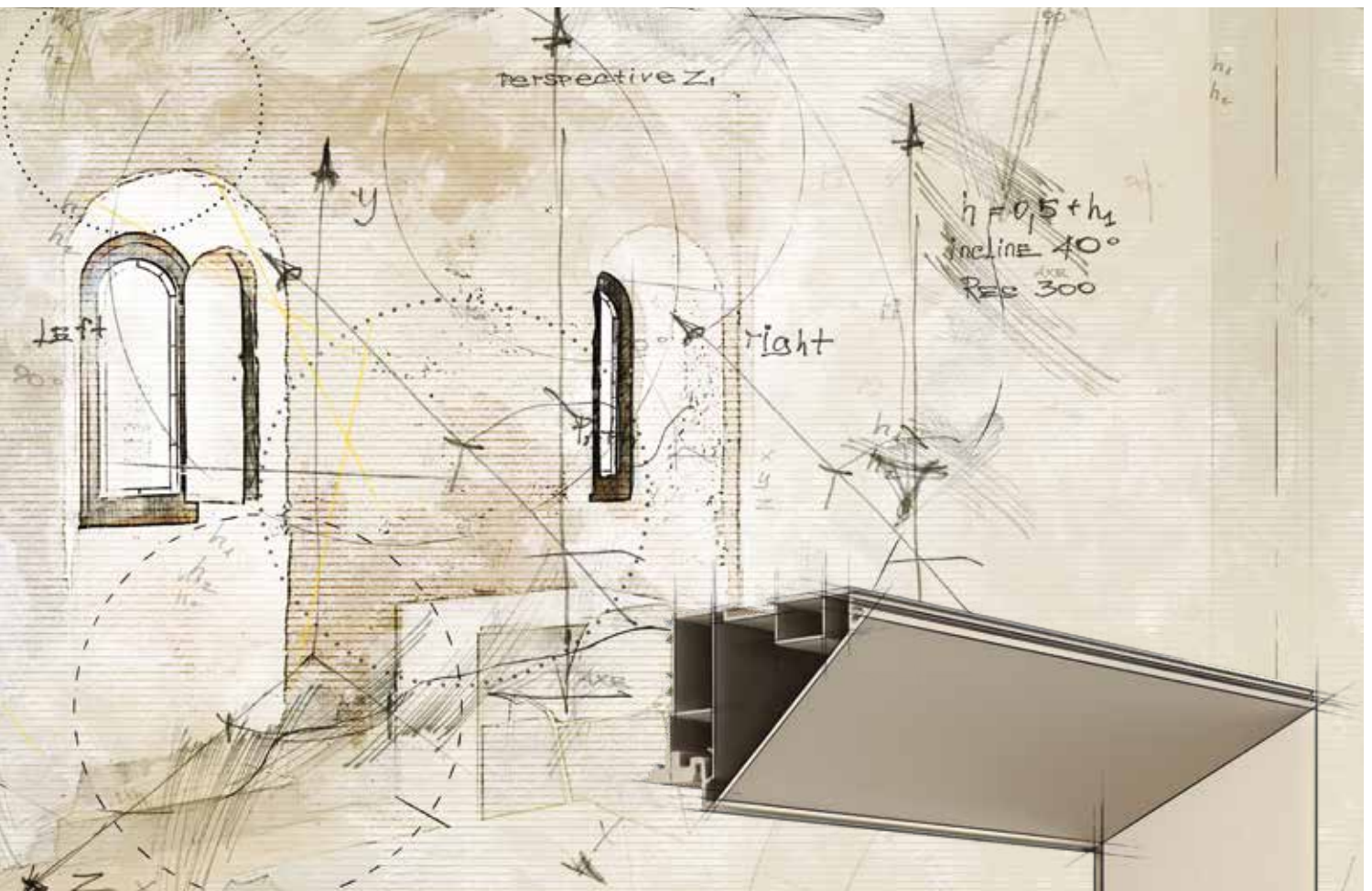

Patent Design

With ECLISSE 40, the frame is shown for the first time: the element emerges from the wall leaving a mark, becoming a discreet but visible presence. The frame is no longer just a technical and functional element, but also a decorative element itself.



5 Points of view, one great innovation

Doing old things in a new way: this is innovation.
J.A. Schumpeter







1. INCLINATION

to progress

The new ECLISSE 40 frame is the result of ECLISSE's quest for perfection, which makes technical detail a priority. A single structure for both solid and stud walls.

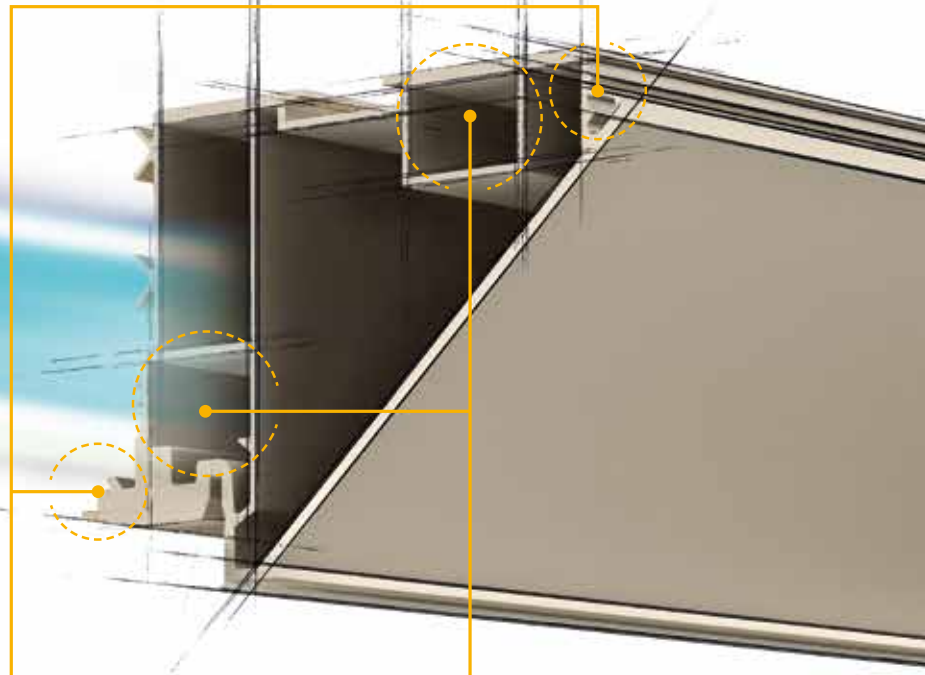

PERFECT FINISH

Special grooves allow a perfect finish flush with the wall, avoiding the formation of cracks.



PROTECTION

The special shape of the frame creates an intrados with the wall splayed at 40 degrees, protecting the sharp edges between the wall and the door.



ROBUST

The fixing chambers stiffen the structure and keep the profiles perfectly at 40 degrees



Each fold of the aluminium profile performs a specific technical task, in order to obtain a beautiful product but also with attention to detail.

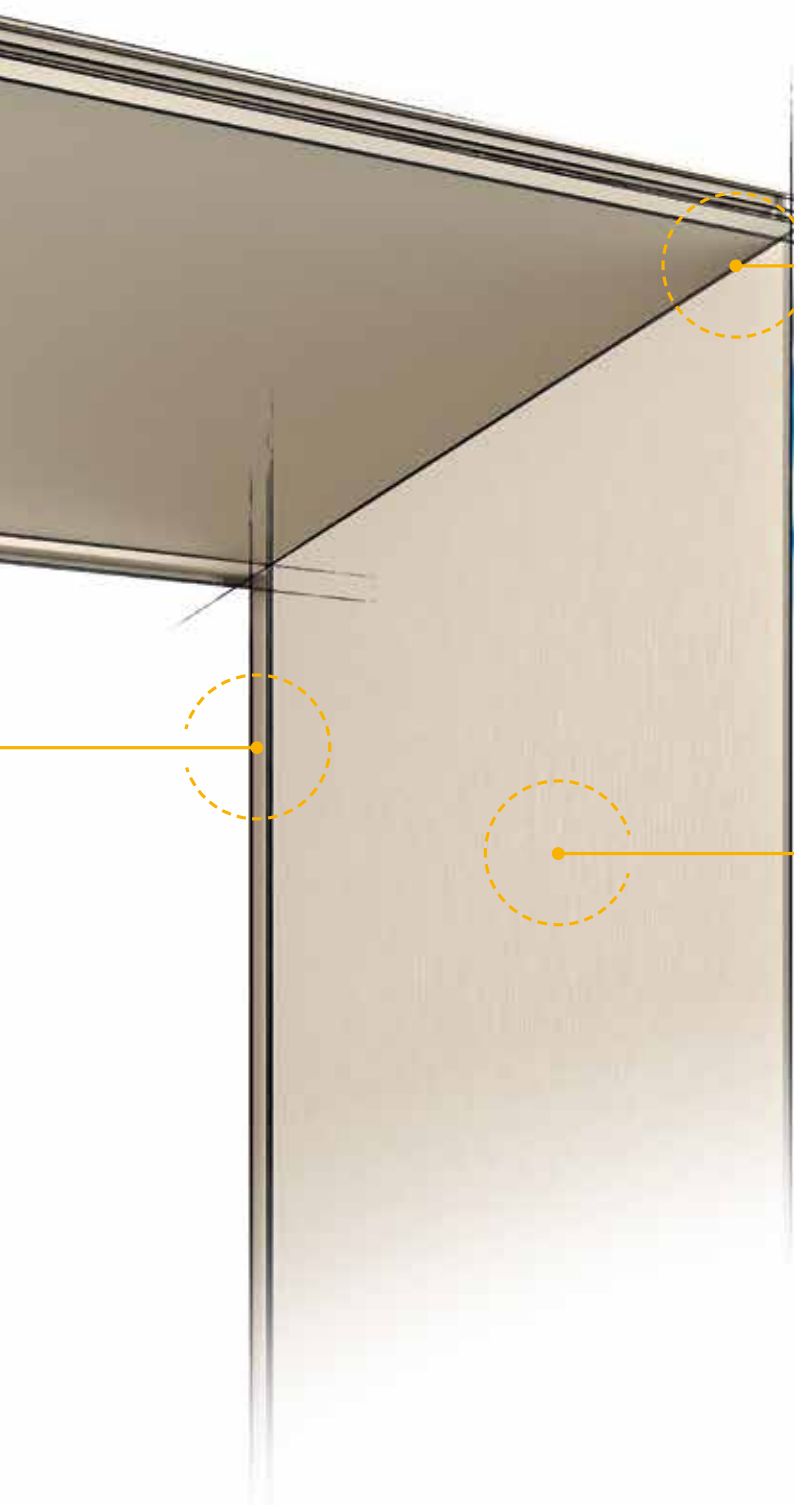

PERFECT JUNCTIONS

Horizontal and vertical profiles match up perfectly to obtain a precise and clean angle.



ANODISED ALUMINIUM

Anodising to 10 microns makes the profile more resistant to corrosion and increases its surface hardness.



The raw version is coated with a primer so that it can be painted in any colour.



2. FINISHINGS

The strength of aluminium

From being an invisible and structural element, for the first time, the frame now displays beauty and design.

Developed by ECLISSE research, this aluminium frame gives the door a special splay, a feature that completes and enhances it, giving it a unique, precise and minimal look.

The frame is made completely of anodised aluminium. The electrochemical process of anodising creates a protection that prevents the wear and tear of the metal and gives it greater resistance to weathering, stains and scratches. Anodising also facilitates repainting: the quality and aesthetics of the colouring are particularly admirable.







2. FINISHINGS

The elegance of aluminium



FINISHING
PRIMER-COATED

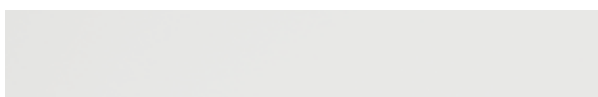

FINISHING
LIGHT BRONZE

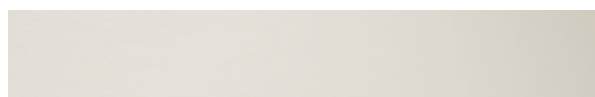

The special inclination of the frame allows it to play on light and shadows, creating a sense of depth and a new look.



FINISHING
DARK BRONZE



FINISHING
GRAPHITE BRONZE

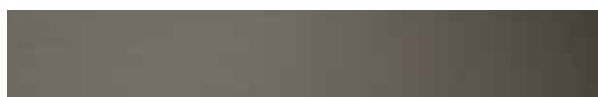

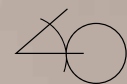

3. DESIGN

The frame as a decorative element

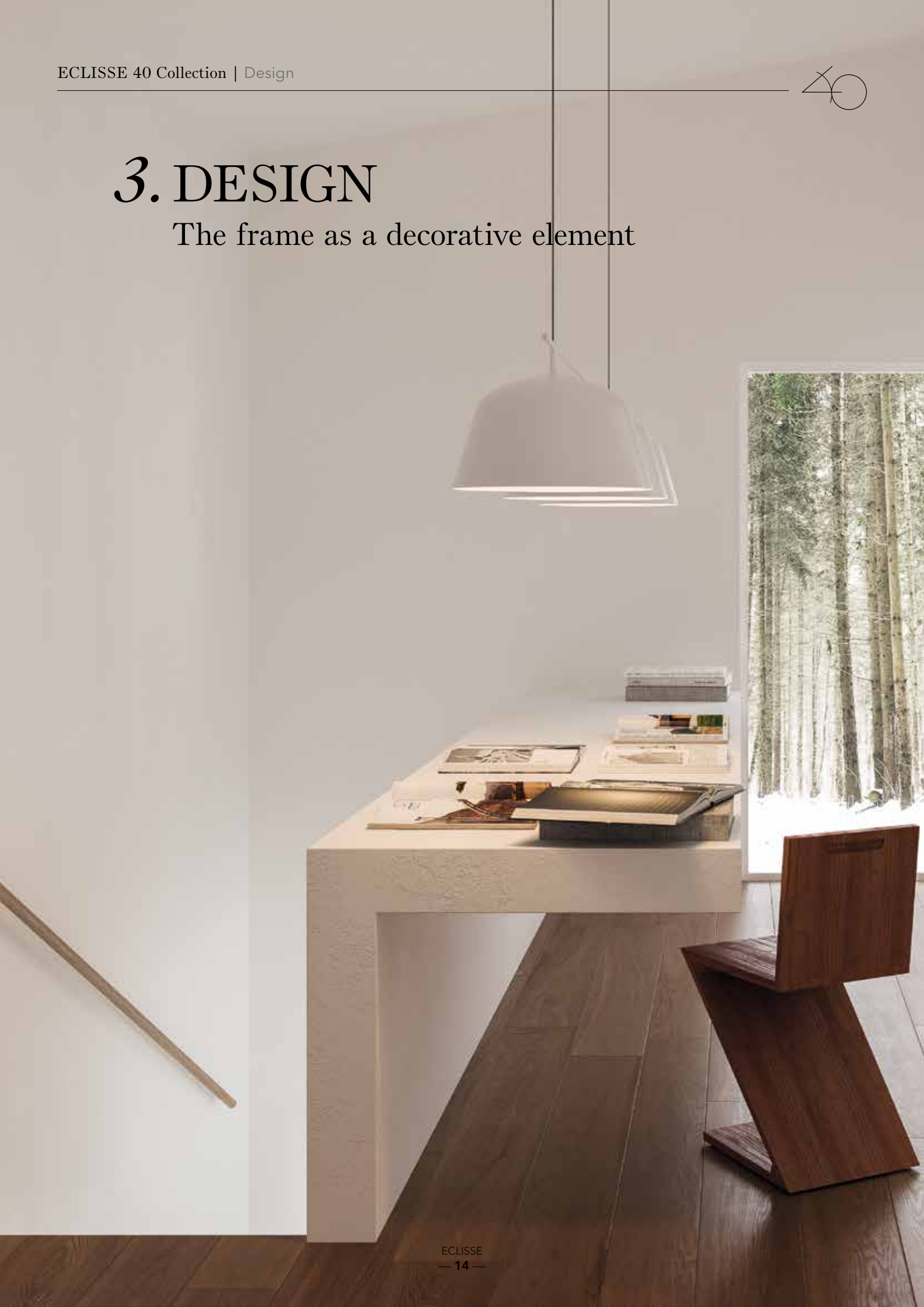



A profound change and a point of no return that, however, does not create distortions and gives the door an important presence. An absolute novelty in the market.



4. VERSATILITY

Beauty becomes versatile



ON ONE SIDE,
a door flush with the
wall gives elegance and
discretion.



ON THE OTHER,
geometric lines that go
deep. The frame empties
the wall and enhances
the room. Like a picture
frame, it encloses the
door and invites us to
cross through it.



5. AMBIENCE

The perfect picture frame for every room

A product designed for a diverse public and a variety of applications.





IT'S NOT HOW
GOOD YOU ARE,
IT'S HOW GOOD
YOU WANT TO BE.
The world's best-selling
book by PAUL ARDEN.

THE
FAST
BOO

INTERIOR
NOUVEAU

Elliott Erwit
Snaps

pierre cardin
at least 100 volumes











Towards perfection

Details that makes the difference

A single frame, for both stud and solid wall. Supplied with a plastic protection to prevent it from getting dirty or being scratched on site.

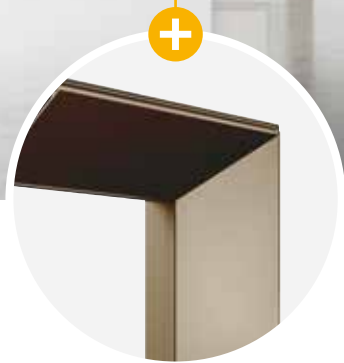

Paintable and durable over time

The aluminium frame undergoes an anodising treatment against oxidation to obtain the different ECLISSE finishings.

The primer-coated version favours the adhesion of the paints.

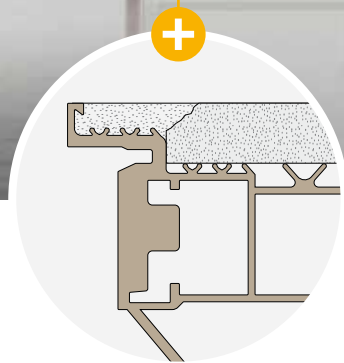

NO cracks!

The frame profile is specifically designed to avoid cracks.



Very robust frame

The frame is made of anodised aluminium and weighs about 3.5 kg per linear meter (for Th. 125 mm)

The quality of ECLISSE products can be seen during installation and in everyday use, but it is the details that make the difference.

Because, besides ease of installation and perfection of the mechanisms, the unique design is appreciated only by looking closely at the product.

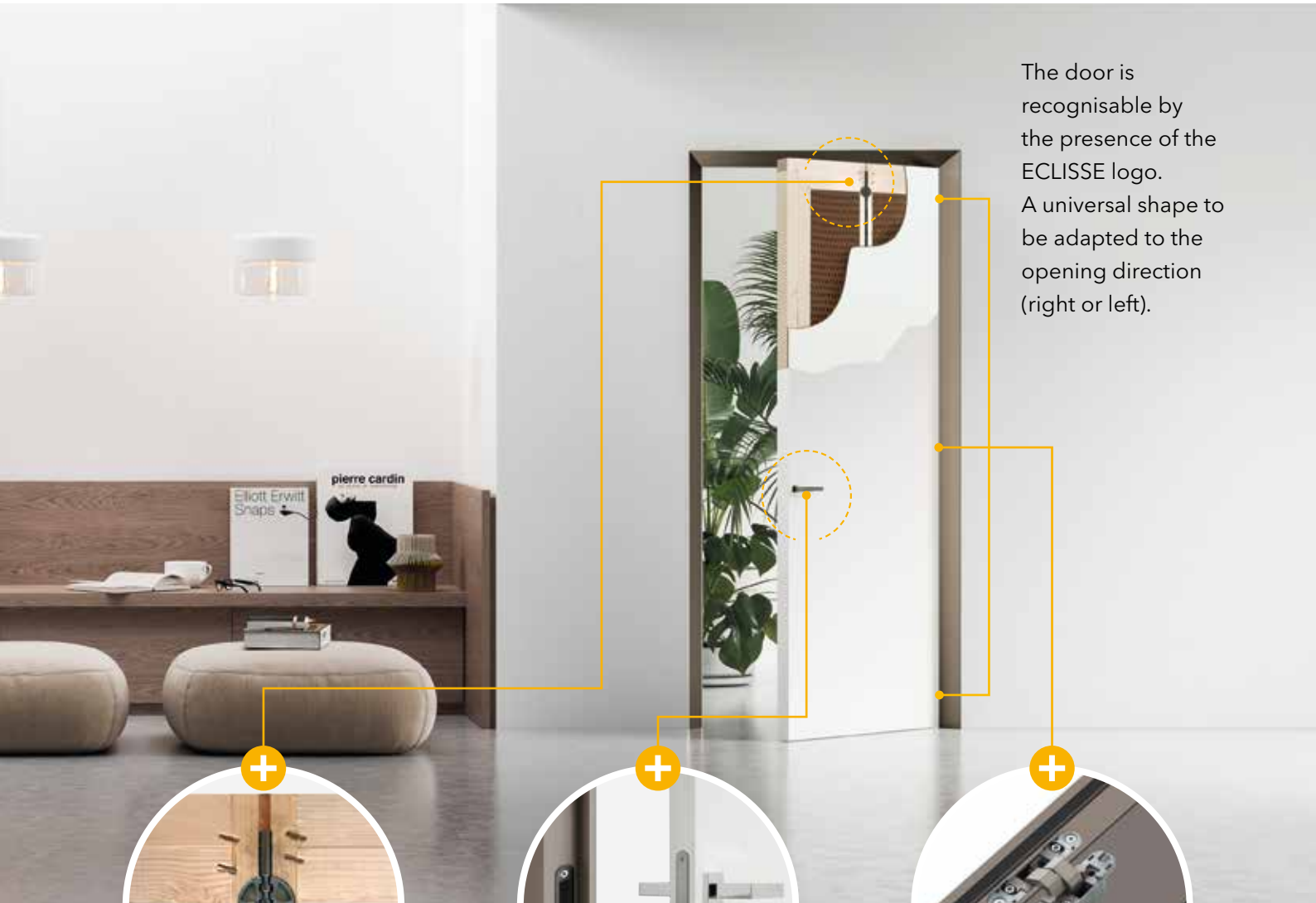

The door is recognisable by the presence of the ECLISSE logo. A universal shape to be adapted to the opening direction (right or left).

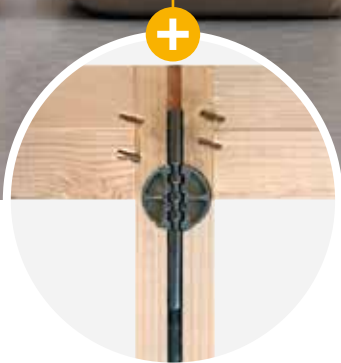

Tensioning rod

A special device adjustable at any time that keeps the door panel in constant tension, ensuring the perfect coplanarity between the door and the wall.

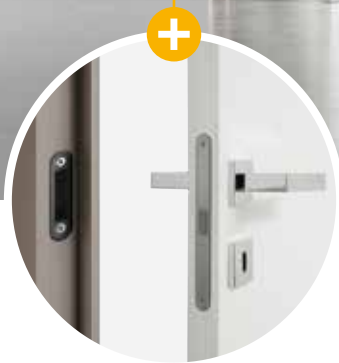

Magnetic lock

With a modern design and minimalist lines, it remains "flush" and ensures an extraordinarily silent closing.

Adjustable strike plate

Minimalist design, stays flush and allows to remedy any small installation imperfection ensuring the perfect closing of the door.



3 Adjustable hinges

Adjustable on the 3 axes (height, width, depth) for a perfect calibration of the perimeter size.

Note: if the weight of the door panel exceeds 50 kg (max 65 kg), 4 hinges are necessary.

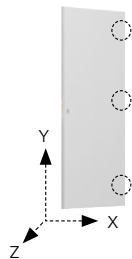



Openings

OPENING TYPES - ECLISSE 40 SINGLE DOOR



PUSH DOOR

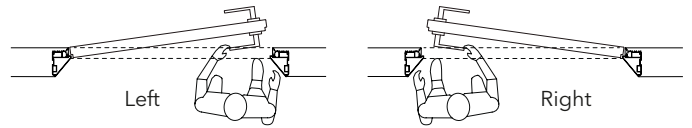

PULL DOOR

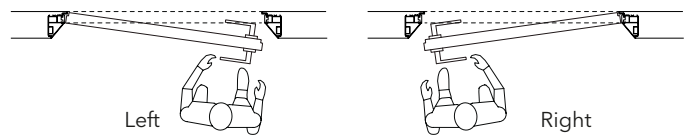

WITH OR WITHOUT HEADER

The peculiarity of ECLISSE 40 is the possibility to be installed full-height, with or without header, in order to obtain an effect of full integration between the door, the wall and the ceiling.

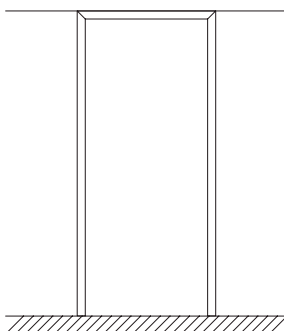

With header

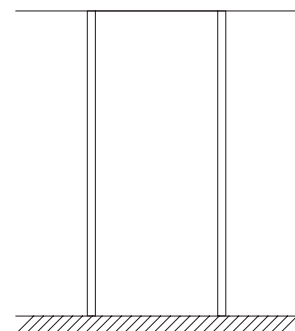
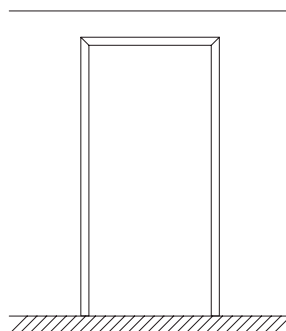

Without header

Openings

OPENING TYPES - ECLISSE 40 DOUBLE DOOR



LEFT PUSH DOOR - RIGHT DOOR FIXED

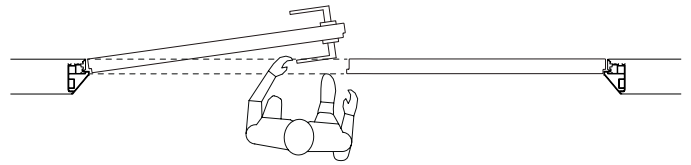

LEFT PULL DOOR - RIGHT DOOR FIXED

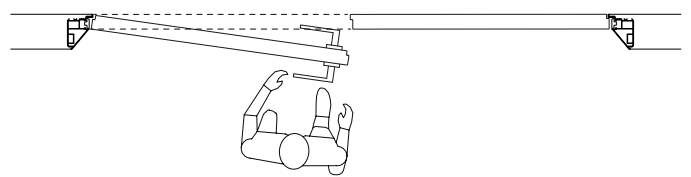

RIGHT PUSH DOOR - LEFT DOOR FIXED

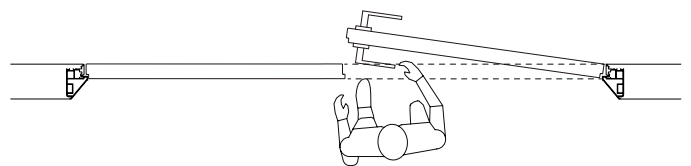

RIGHT PULL DOOR - LEFT DOOR FIXED

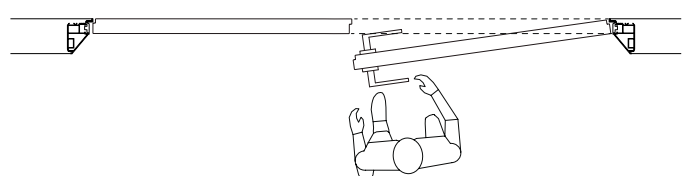

ONLY WITH HEADER

ECLISSE 40 DOUBLE is available with header only

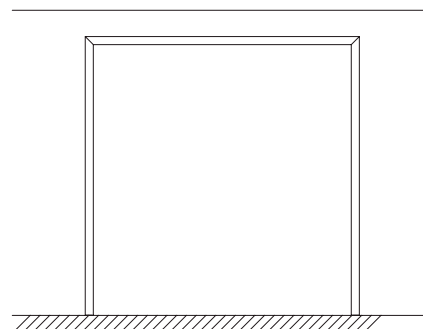
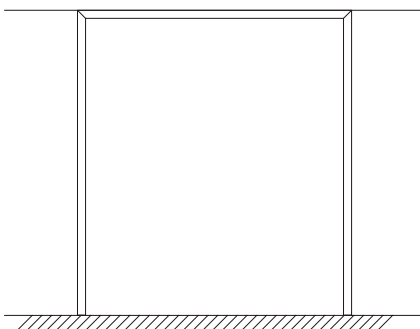

With header



Components

SUPPLY METHODS



COMPLETE SET

FRAME + PRIMER-COATED DOOR PANEL + HARDWARE



SINGLE ELEMENTS

HARDWARE SET FOR ECLISSE 40 (handle not included)



Black door gasket to be cut to the required length, white for the primer-coated version



Magnetic lock available with or without key and with thumb turn



Black adjustable strike plate, satin chrome for the primer-coated version

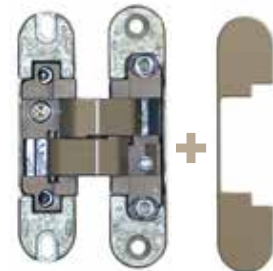

Hinges and Hinge covers available in colors matching the frame finishings



Screw bag

FLUSH BASEBOARD

ECLISSE 40 can be matched to the ECLISSE flush baseboard, an aluminium profile designed to allow the installation of a 58 mm high flush to the wall skirting. For a higher skirting, it is enough to place the profiles above the finished floor level.

SOLID WALL version



STUD WALL version



Applications

PUSH DOOR

PULL DOOR

Frame on solid wall - Finished wall thickness 108 mm

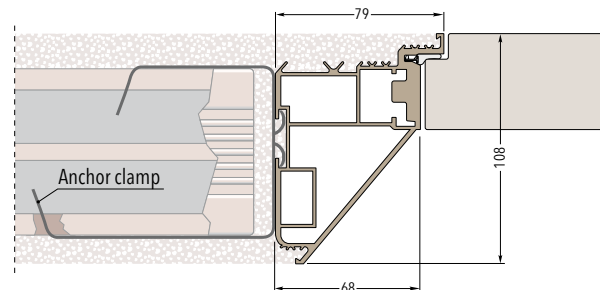
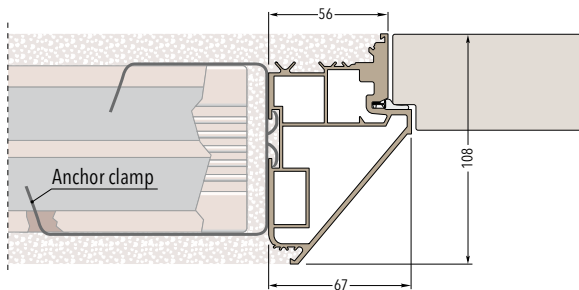

Frame on solid wall - Finished wall thickness 125 mm

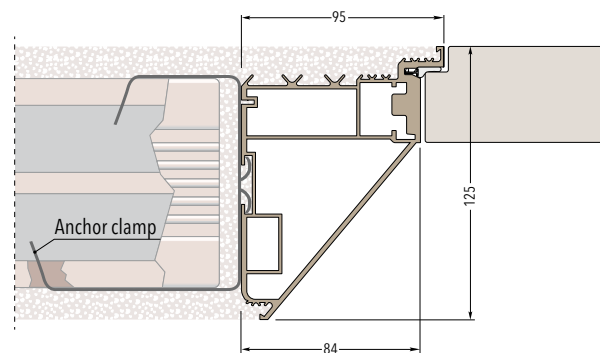
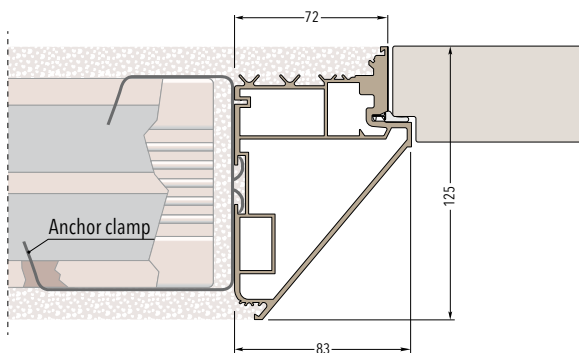

Frame on stud wall with one plasterboard - Finished wall thickness 100 mm

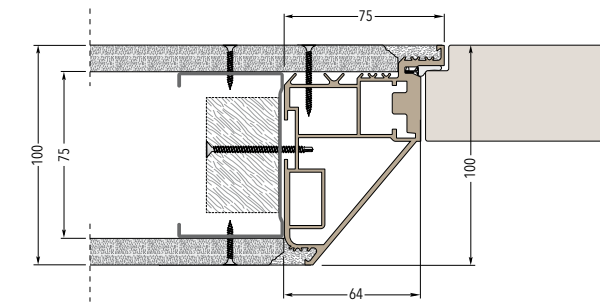
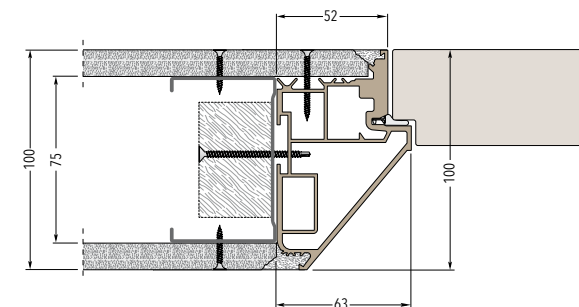

Frame on stud wall with two plasterboards - Finished wall thickness 125 mm

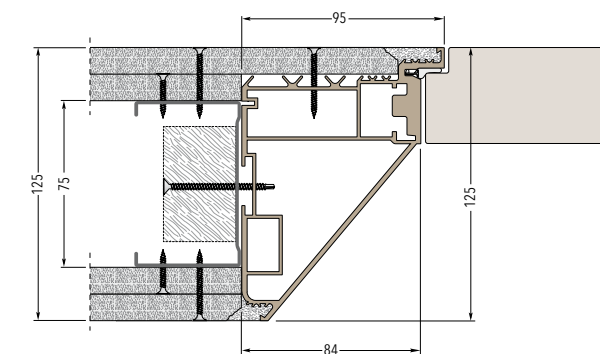
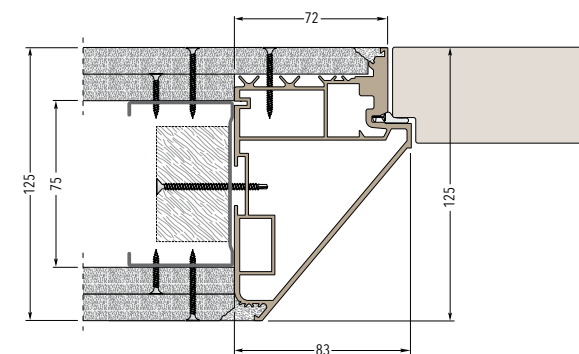

The frame fits both stud and solid wall. For solid wall 6 clamps are cemented in the special spaces created in the wall. For stud wall the frame is fixed with screws to the metal structure through the existing holes.



SIZES - ECLISSE 40 SINGLE

PUSH DOOR | PULL DOOR - FRAME WITH HEADER - SINGLE DOOR PANEL

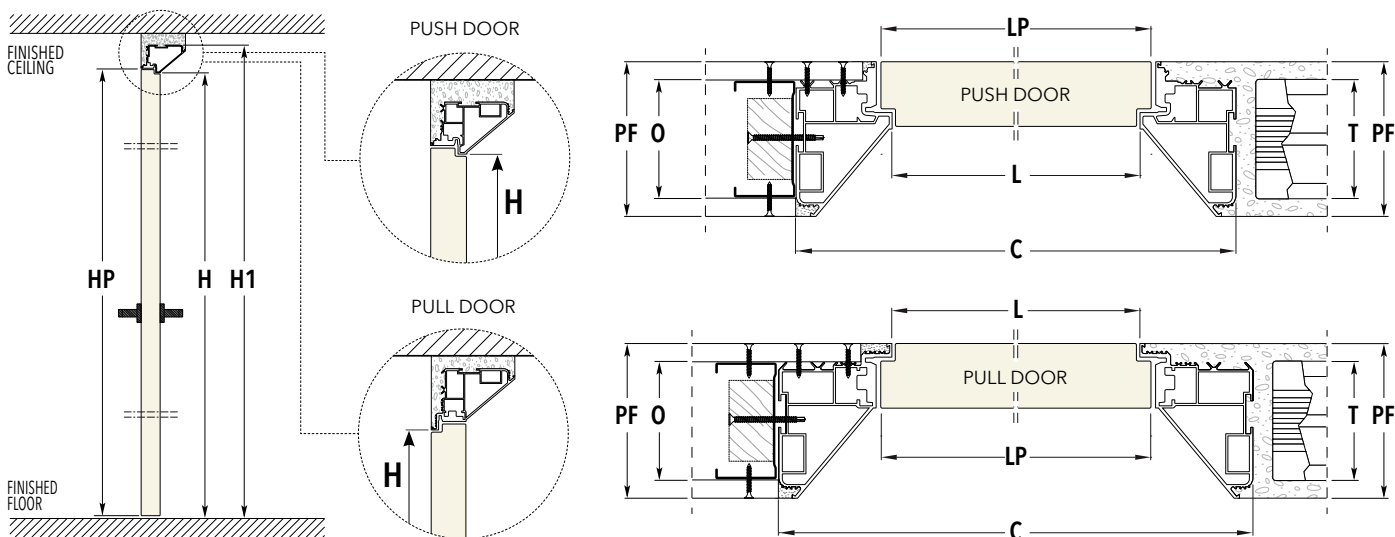

FINISHED WALL THICKNESS - 100							
PASSAGE SIZE		PUSH OVERALL DIMENSIONS		PULL OVERALL DIMENSIONS		DOOR PANEL - TH. 45 mm	
L	H	C	H1	C	H1	LP	HP
600	2100/2400	726	2163/2463	750	2175/2475	616	2104/2404
700	2100/2400	826	2163/2463	850	2175/2475	716	2104/2404
800	2100/2400	926	2163/2463	950	2175/2475	816	2104/2404
900	2100/2400	1026	2163/2463	1050	2175/2475	916	2104/2404
1000	2100/2400	1126	2163/2463	1150	2175/2475	1016	2104/2404

FINISHED WALL THICKNESS - 108							
PASSAGE SIZE		PUSH OVERALL DIMENSIONS		PULL OVERALL DIMENSIONS		DOOR PANEL - TH. 45 mm	
L	H	C	H1	C	H1	LP	HP
600	2100/2400	734	2167/2467	758	2179/2479	616	2104/2404
700	2100/2400	834	2167/2467	858	2179/2479	716	2104/2404
800	2100/2400	934	2167/2467	958	2179/2479	816	2104/2404
900	2100/2400	1034	2167/2467	1058	2179/2479	916	2104/2404
1000	2100/2400	1134	2167/2467	1158	2179/2479	1016	2104/2404

FINISHED WALL THICKNESS - 125							
PASSAGE SIZE		PUSH OVERALL DIMENSIONS		PULL OVERALL DIMENSIONS		DOOR PANEL - TH. 45 mm	
L	H	C	H1	C	H1	LP	HP
600	2100/2400	766	2183/2483	790	2195/2495	616	2104/2404
700	2100/2400	866	2183/2483	890	2195/2495	716	2104/2404
800	2100/2400	966	2183/2483	990	2195/2495	816	2104/2404
900	2100/2400	1066	2183/2483	1090	2195/2495	916	2104/2404
1000	2100/2400	1166	2183/2483	1190	2195/2495	1016	2104/2404

THICKNESS AVAILABLE	SOLID WALL		STUD WALL	
	FINISHED WALL= PF	BRICK= T	FINISHED WALL= PF	STUDWORK= O
--	--	--	100	50 - double plasterboard 75 - single plasterboard
108	80	--	--	--
125	100	125	75 - double plasterboard	100 - single plasterboard

dimensions are given in mm

► Intervals for height every 50 mm, from 1650 mm to 2700 mm

SIZES - ECLISSE 40 SINGLE

PUSH DOOR | PULL DOOR - FRAME WITHOUT HEADER - SINGLE DOOR PANEL

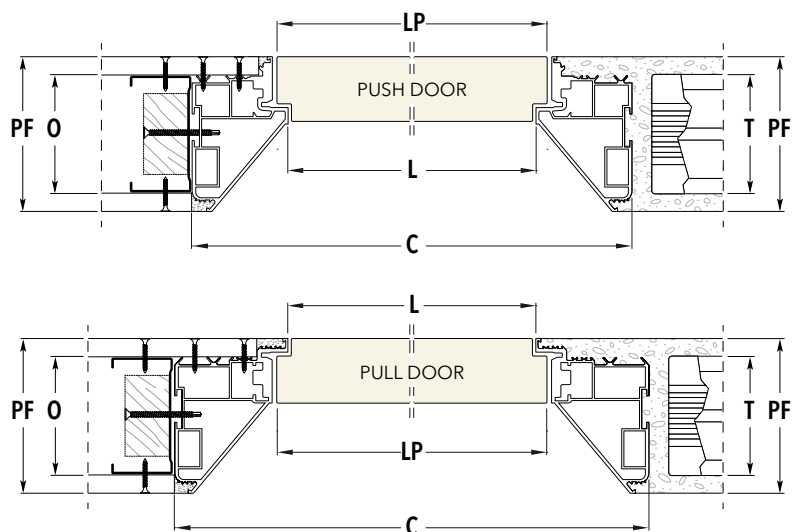
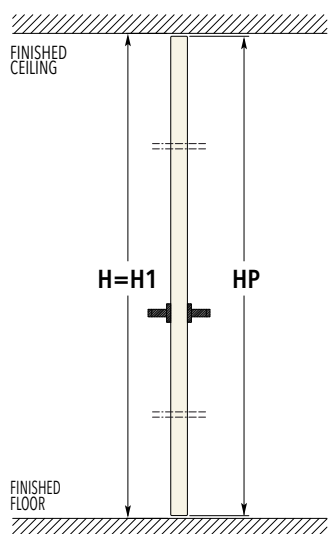

FINISHED WALL THICKNESS - 100

PASSAGE SIZE		PUSH		PULL		DOOR PANEL - TH. 45 mm	
L	H	OVERALL DIMENSIONS		OVERALL DIMENSIONS		LP	HP
		C	H1	C	H1		
600	2700	726	2700	750	2700	616	2693
700	2700	826	2700	850	2700	716	2693
800	2700	926	2700	950	2700	816	2693
900	2700	1026	2700	1050	2700	916	2693
1000	2700	1126	2700	1150	2700	1016	2693

FINISHED WALL THICKNESS - 108

PASSAGE SIZE		PUSH		PULL		DOOR PANEL - TH. 45 mm	
L	H	OVERALL DIMENSIONS		OVERALL DIMENSIONS		LP	HP
		C	H1	C	H1		
600	2700	734	2700	758	2700	616	2693
700	2700	834	2700	858	2700	716	2693
800	2700	934	2700	958	2700	816	2693
900	2700	1034	2700	1058	2700	916	2693
1000	2700	1134	2700	1158	2700	1016	2693

FINISHED WALL THICKNESS - 125

PASSAGE SIZE		PUSH		PULL		DOOR PANEL - TH. 45 mm	
L	H	OVERALL DIMENSIONS		OVERALL DIMENSIONS		LP	HP
		C	H1	C	H1		
600	2700	766	2700	790	2700	616	2693
700	2700	866	2700	890	2700	716	2693
800	2700	966	2700	990	2700	816	2693
900	2700	1066	2700	1090	2700	916	2693
1000	2700	1166	2700	1190	2700	1016	2693

THICKNESS AVAILABLE	SOLID WALL		STUD WALL	
	FINISHED WALL= PF	BRICK= T	FINISHED WALL= PF	STUDWORK= O
--	--	--	100	50 - double plasterboard 75 - single plasterboard
108	80	--	--	--
125	100	125	75 - double plasterboard 100 - single plasterboard	

dimensions are given in mm

- ▶ Intervals for height every 50 mm, from 1650 mm to 2700 mm
- ▶ In the version without header, intervals for height every 10 mm



SIZES - ECLISSE 40 DOUBLE

PUSH DOOR | FRAME WITH HEADER ONLY - DOUBLE DOOR PANEL

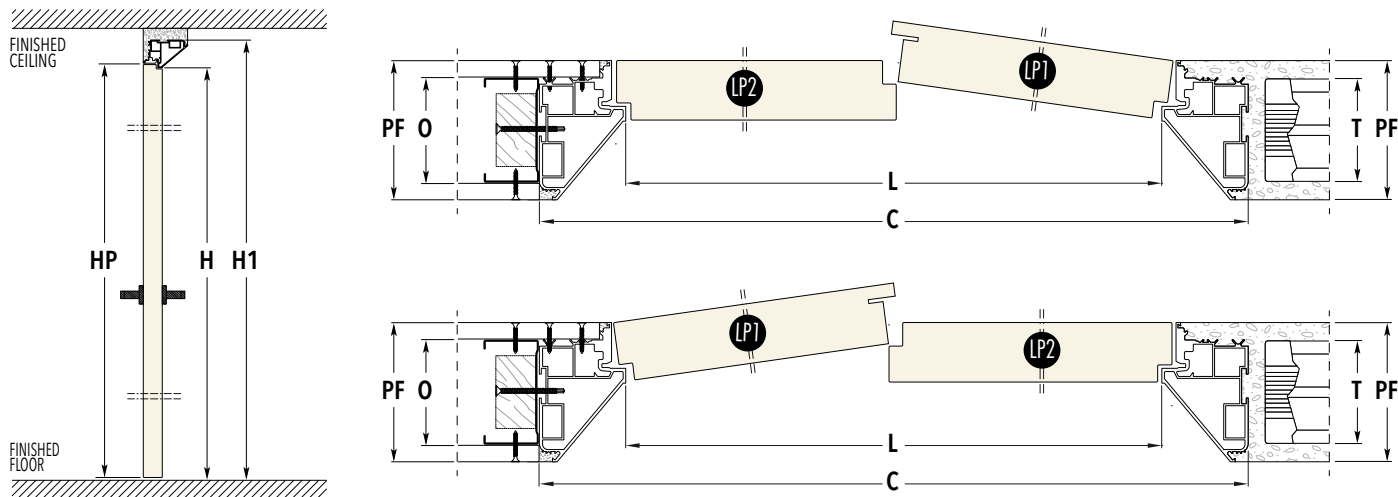

FINISHED WALL THICKNESS - 100

PUSH							
PASSAGE SIZE		OVERALL DIMENSIONS		DOOR PANEL - TH. 45 mm			
L	H	C	H1	LP1	LP2	HP	
1200	2100/2400	1326	2163/2463	606	616	2104/2404	
1400	2100/2400	1526	2163/2463	706	716	2104/2404	
1600	2100/2400	1726	2163/2463	806	816	2104/2404	
1800	2100/2400	1926	2163/2463	906	916	2104/2404	
2000	2100/2400	2126	2163/2463	1006	1016	2104/2404	

FINISHED WALL THICKNESS - 108

PUSH							
PASSAGE SIZE		OVERALL DIMENSIONS		DOOR PANEL - TH. 45 mm			
L	H	C	H1	LP1	LP2	HP	
1200	2100/2400	1334	2167/2467	606	616	2104/2404	
1400	2100/2400	1534	2167/2467	706	716	2104/2404	
1600	2100/2400	1734	2167/2467	806	816	2104/2404	
1800	2100/2400	1934	2167/2467	906	916	2104/2404	
2000	2100/2400	2134	2167/2467	1006	1016	2104/2404	

FINISHED WALL THICKNESS - 125

PUSH							
PASSAGE SIZE		OVERALL DIMENSIONS		DOOR PANEL - TH. 45 mm			
L	H	C	H1	LP1	LP2	HP	
1200	2100/2400	1366	2183/2483	606	616	2104/2404	
1400	2100/2400	1566	2183/2483	706	716	2104/2404	
1600	2100/2400	1766	2183/2483	806	816	2104/2404	
1800	2100/2400	1966	2183/2483	906	916	2104/2404	
2000	2100/2400	2166	2183/2483	1006	1016	2104/2404	

THICKNESS AVAILABLE	SOLID WALL		STUD WALL	
	FINISHED WALL= PF	BRICK= T	FINISHED WALL= PF	STUDWORK= O
--	--	--	100	50 - double plasterboard 75 - single plasterboard
108	--	80	--	--
125	--	100	125	75 - double plasterboard 100 - single plasterboard

dimensions are given in mm

- ▶ Intervals for height every 50 mm, from 1650 mm to 2700 mm
- ▶ Possibility to install asymmetrical door panels

SIZES - ECLISSE 40 DOUBLE

PULL DOOR | FRAME WITH HEADER ONLY - DOUBLE DOOR PANEL

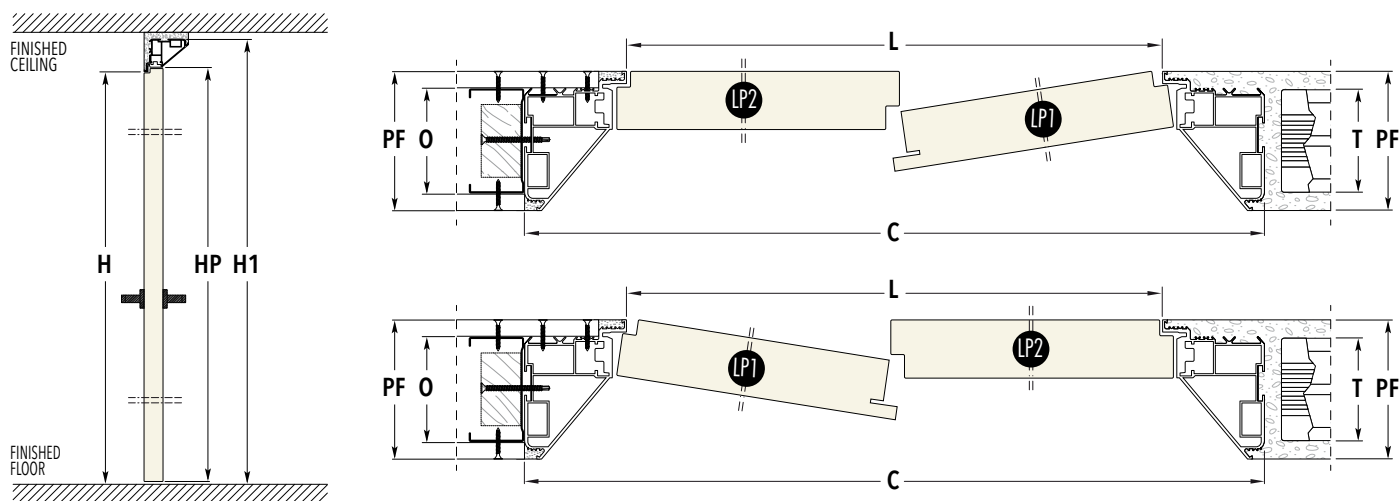

FINISHED WALL THICKNESS - 100

PULL							
PASSAGE SIZE		OVERALL DIMENSIONS		DOOR PANEL - TH. 45 mm			
L	H	C	H1	LP1	LP2	HP	
1200	2100/2400	1350	2175/2475	606	616	2104/2404	
1400	2100/2400	1550	2175/2475	706	716	2104/2404	
1600	2100/2400	1750	2175/2475	806	816	2104/2404	
1800	2100/2400	1950	2175/2475	906	916	2104/2404	
2000	2100/2400	2150	2175/2475	1006	1016	2104/2404	

FINISHED WALL THICKNESS - 108

PULL							
PASSAGE SIZE		OVERALL DIMENSIONS		DOOR PANEL - TH. 45 mm			
L	H	C	H1	LP1	LP2	HP	
1200	2100/2400	1358	2179/2479	606	616	2104/2404	
1400	2100/2400	1558	2179/2479	706	716	2104/2404	
1600	2100/2400	1758	2179/2479	806	816	2104/2404	
1800	2100/2400	1958	2179/2479	906	916	2104/2404	
2000	2100/2400	2158	2179/2479	1006	1016	2104/2404	

FINISHED WALL THICKNESS - 125

PULL							
PASSAGE SIZE		OVERALL DIMENSIONS		DOOR PANEL - TH. 45 mm			
L	H	C	H1	LP1	LP2	HP	
1200	2100/2400	1390	2195/2495	606	616	2104/2404	
1400	2100/2400	1590	2195/2495	706	716	2104/2404	
1600	2100/2400	1790	2195/2495	806	816	2104/2404	
1800	2100/2400	1990	2195/2495	906	916	2104/2404	
2000	2100/2400	2190	2195/2495	1006	1016	2104/2404	

THICKNESS AVAILABLE	SOLID WALL		STUD WALL	
	FINISHED WALL= PF	BRICK= T	FINISHED WALL= PF	STUDWORK= O
--	--	--	100	50 - double plasterboard 75 - single plasterboard
108	--	80	--	--
125	--	100	125	75 - double plasterboard 100 - single plasterboard

dimensions are given in mm

- ▶ Intervals for height every 50 mm, from 1650 mm to 2700 mm
- ▶ Possibility to install asymmetrical door panels



The doors



The door panels for ECLISSE 40 are available in the following finishings:

- untreated primer-coated door panels, ready to be painted or lacquered
- Alkorcell® door panels in brushed white or grey
- lacquered door panels in different RAL colours
- door panels in wooden essences such as natural oak, white ash, natural ash, open pore white lacquered RAL 9010 ash

Door panels have a standard tensioning rod starting from H 2000 mm.

FINISHINGS

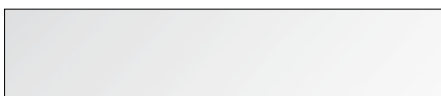

PRIMER COATED



WHITE LACQUERED RAL 9010



OTHER RAL COLOURS LACQUERING



DECORATED ALKORCELL® BRUSHED WHITE



DECORATED ALKORCELL® BRUSHED GREY



NATURAL OAK



WHITE ASH

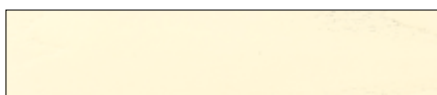

OPEN PORE WHITE LACQUERED RAL 9010 ASH



NATURAL ASH

The handle 40+one

These handles with clean lines, each one obtained from a single ingot of solid brass, are the result of the synergy between the Mandelli1953 brand and the two designers Valentini and Ponzelli.

Inspired by the ECLISSE 40 Collection, it's manufactured in four finishings exclusively for ECLISSE.

40+one

SATIN-FINISH NICKEL



40+one

POLISHED NICKEL



40+one

MATT GRAPHITE



40+one

POLISHED PEARL-BLACK





The installation

Easy and quick assembly



ECLISSE 40 FRAME ON STUD WALL

Once the frame has been removed from the packaging, place it inside the wall opening prepared with a reinforced studwork or a solid wood structure.

Fix ECLISSE 40 carefully checking the correct levelling of the frame. Remove the OSB spacers.

DO NOT REMOVE THE CARDBOARD PROTECTIONS.

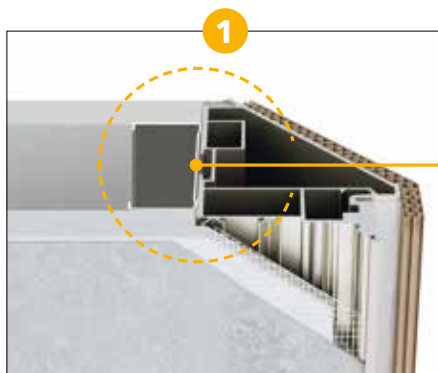

1
Apply the plasterboards.
The application of a plasterboard scrim tape along the entire perimeter is recommended.

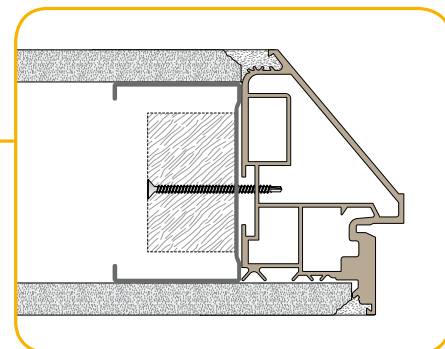

Sectional view of the screw on the studwork.



2
DO NOT remove the cardboard protections.
Place masking tape on both sides along the entire perimeter to protect the visible aluminium part and plaster.

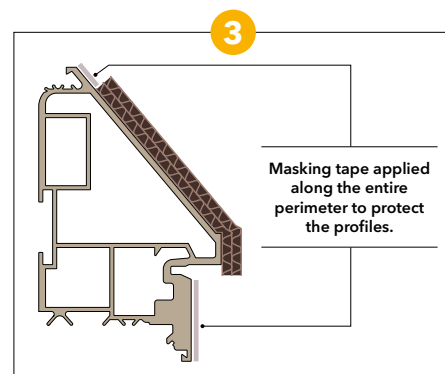

3
Flush to the wall finish.



4
Remove the adhesive tape after each finishing coat before it dries to avoid cracks.

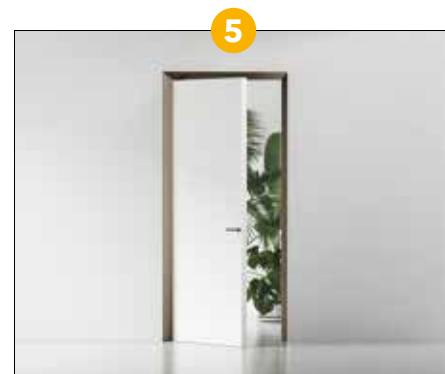

5
Remove the protections from the frame.
Secure the door panel and its hardware. Then proceed with the painting of the door (if it is a raw primer-coated door panel).
DO NOT remove the anti-scratch protections.



ECLISSE 40 FRAME ON SOLID WALL

Once the frame has been removed from the packaging, place it inside the wall opening carefully checking the correct levelling of the frame. Fix ECLISSE 40 by blocking the 6 clamps (3 on each sides) with mortar inside the holes previously made in the bricks.

**DO NOT REMOVE THE
CARDBOARD PROTECTIONS.**



DO NOT remove the cardboard protections.
Place masking tape on both sides along the entire perimeter to protect the visible aluminium part.

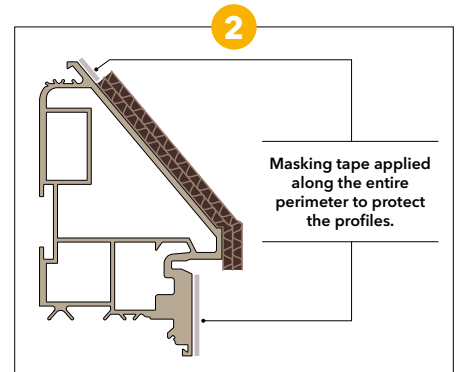

Flush to the wall finish.

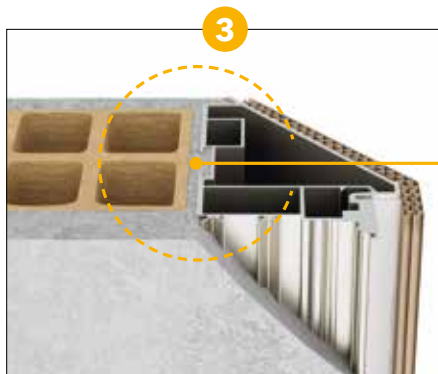

Proceed to plaster and skim the wall.

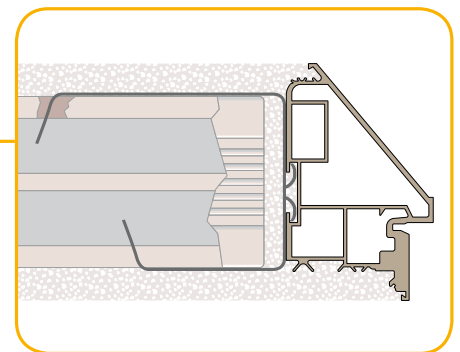

Sectional view of the anchor clamp.



Remove the adhesive tape after each finishing coat before it dries to avoid cracks.

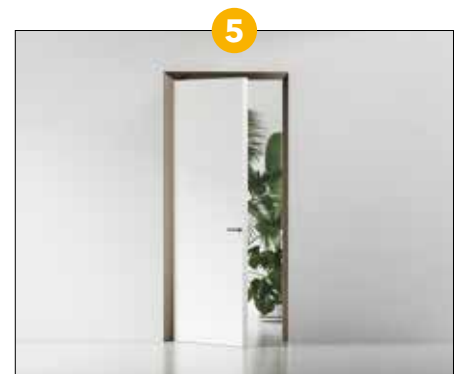

Remove the protections from the frame. Secure the door panel and its hardware. Then proceed with the painting of the door (if it is a raw primer-coated door panel). **DO NOT remove the anti-scratch protections.**

© ECLISSE, all rights reserved. The use, filing and total or partial reproduction, using any mechanical or electronic means, of texts, drawings and pictures contained in this publication is strictly prohibited, unless specifically approved in writing by ECLISSE. All pictures and drawings are for illustrative purposes only. ECLISSE s.r.l. reserves the right to make changes in order to improve the product specifications without notice. We may change the content of this catalogue, so if you have any queries related to the products you can contact our call center. ECLISSE refuses any responsibility for misprints, clerical errors or for any other reason.

Graphic design: **ECLISSE Marketing and Fkdesign**
Set design / styling: **Lisa De Chirico**
Digital images: **creativeblend.it**
Printing: **Scarpis**

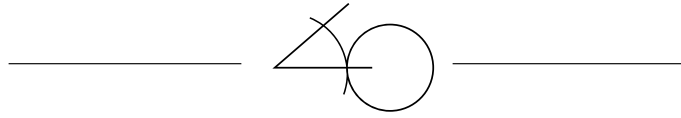

ECLISSE 40 Collection
THE FRAME SEEN FROM A NEW PERSPECTIVE



Via Sernaglia, 76 | 31053 Pieve di Soligo TV | T. +39 0438 985749 | F. +39 0438 837245 | international.sales@eclisse.it | www.eclisseworld.com

Follow us on:

